

CASHFLOW® MEI-PAY - THE INTEGRATED CASHLESS RANGE

mei | cashflow®
mei-pay series

Freedom of MIFARE®
open standard

Increased sales with the
choice of Cash & Cashless

Benefit of the
integration that delivers
the lowest cost solution



mei®

www.meigroup.com

The Complete Payment Solution

CashFlow® mei-pay is a complete range of Cashless solutions that adapts to the needs of every application. Individual customers have a variety of requirements, some are looking for a simple additional payment option to cash, others demand integration with existing access and identification cards or a range of discounts and bonus rewards for employees.

CashFlow® mei-pay is based on MIFARE® technology, which, as an open standard, provides the flexibility you need to respond to your customers' varied needs. MIFARE® also offers the benefits of a contactless solution: with no moving parts or key insertion required, reliability is assured.

CASHFLOW® MEI-PAY MDB READER

- Provides in machine revaluation and dual pricing option
- For use in conjunction with the CF690 and CF7000 as a coin and cashless offering or as a stand-alone cashless solution in MDB machines
- Compatible with all level MDB machines

DIMENSIONS:	110 x 62 x 25 mm
OPERATING TEMPERATURE:	-20°C to +50°C
OPERATING VOLTAGE:	9 to 40 VDC
POWER CONSUMPTION:	2 W
INTERFACE:	MDB
CONNECTIVITY:	USB, RS232
COMPATIBILITY:	compatible with mei-pay multi bezel, mei-pay e-key bezel and optional display



CASHFLOW® MEI-PAY MASTER READER

- The solution for table top and stand-alone cashless applications
- Compatible with Executive and Parallel interface machines

DIMENSIONS:	110 x 102 x 25 mm
OPERATING TEMPERATURE:	-20°C to +50°C
OPERATING VOLTAGE:	9 to 40 VDC
POWER CONSUMPTION:	2.5 W
INTERFACE:	MDB, EXEC, BDV, Parallel
CONNECTIVITY:	USB, IrDA, RS232
COMPATIBILITY:	compatible with mei-pay multi bezel, mei-pay e-key bezel and optional display



CASHFLOW® 8000 WITH INTEGRATED CASHLESS READER

- Cost effective because of reduced duplication of electronic components
- Compatible with all machine types
- Delivering full machine audit from one source
- Additional MDB peripheral connector allows a note reader to be incorporated

DIMENSIONS:	371 x 138 x 80 mm
OPERATING VOLTAGE:	24 VDC
POWER CONSUMPTION:	2 W
INTERFACES:	MDB, EXEC, BDV
CONNECTIVITY:	USB, IrDA, Bluetooth® (optional)
COMPATIBILITY:	compatible with mei-pay multi bezel, mei-pay e-key bezel and optional display

**MEI-PAY ACCESSORIES****BEZELS:**

Both bezels offer an option of taking audit via audit key and diagnostics via easy to read tri-coloured LEDs.

MEI-PAY MULTI-BEZEL

DIMENSIONS:	80 x 76 x 26 mm
DISPLAY LEDs:	green, yellow, red
FITTING:	front panel
DRILL HOLE:	4 x 4 mm (fitting)
DRILL HOLE:	2 x 12 mm (cables)

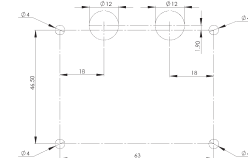
**MEI-PAY E-KEY BEZEL**

DIMENSIONS:	Ø 32.5 mm
DISPLAY LEDs:	green, yellow, red
FITTING:	front panel

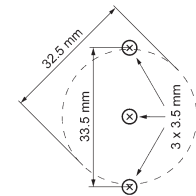
**MEDIA:**

mei-pay range is available with several types of media, which can be customised with individual logos:

**DISPLAY:**

DIMENSIONS:	10.8 x 56.2 mm
DISPLAY:	LCD 3 x 16 characters
OPERATING VOLTAGE:	5 VDC
POWER CONSUMPTION:	625 mW
FITTING:	front panel

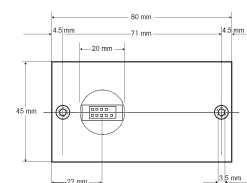

System benefits:

- Profitability – wider choice of payment options to increase consumer spending
- Flexibility of pricing – price increments from 1c
- Low cost of ownership – having no moving parts reduces maintenance costs
- Ease of use – from installation and programming to diagnostics via tri-coloured LEDs and taking audit
- Reliability - robust design with minimal wear and tear
- Quality – proven MICROTRONIC technology inside

Ease of Programming:

- With high speed Windows XP set up via intuitive menu, mei-pay can be as simple or sophisticated as you want it to be
- Programmable using set-up key
- Media can be auto configured to work on a site on first insertion
- Lost or stolen cards can be blocked from the system
- Security option to allocate individual codes to each site
- Secure site identification codes are hidden from unauthorised programmers. Your information and that of your customers is secure
- Windows compatible mei-pay STS support tool

Variety of Bonus Options:

- Real time clock ensures a wide variety of bonus types including discounts and bonus periods
- Individual cards can be programmed with up to 9 bonus periods per day
- Free vend options that can be reset or carried over at the end of the day
- Loyalty bonuses triggered by usage
- User groups within a site can be set up to give different bonuses to different groups of employees
- Subsidies can be set by selection or by user

Compliance:

- Audit fully compatible with EVA/DTS standard
- Compatible with EVA/DTS and EVA/CVS
- MIFARE® registered architecture
- Windows based service tools compatible with Windows 98, 2000 and XP
- Compatibility with existing management systems

MEI OFFICES:

**MEI UK
EUROPEAN HEADQUARTERS**
Unit 51/52,
Suttons Business Park,
Suttons Park Avenue,
Reading, RG6 1AZ
Tel: +44 (0) 845 0944 370
Fax: +44 (0) 118 907 4060
eurovending.sales@meigroup.com
technicalsupport@meigroup.com

MEI HQ UNITED STATES
1301 Wilson Drive
West Chester, PA 19380
Tel: +1 610 430 2500
Fax: +1 610 430 2694

MEI SWITZERLAND
Chemin du Pont-Du-Centenaire 109
Plan-les-Quates, PO Box 2650
Geneva 2
Tel: +41 (0) 228 840 505
Fax: +41 (0) 228 840 504

CUSTOMER SERVICE:

UK
Tel: +44 (0) 845 094 4380
Fax: +44 (0) 118 907 4061

GERMANY
Tel: +49 (0) 695 007 0420
Fax: +49 (0) 695 007 0421

SWITZERLAND
Tel: +41 (0) 228 840 410
Fax: +41 (0) 228 840 411

SPAIN
Tel: +34 917 497 516
Fax: +34 917 499 356

FRANCE
Tel: +33 (0) 1 57 32 30 23
Fax: +33 (0) 1 55 69 56 10

ITALY
Tel: +39 (0) 2 69 63 37 22
Fax: +39 (0) 2 69 63 37 23

REST OF EUROPE
Tel: +44 (0) 845 094 4390
Fax: +44 (0) 118 907 4062



www.meigroup.com

The Complete Payment Solution

MEI CASHFLOW is a registered trademark of MEI. Information is subject to change without notice. MEI has made every effort to assure that the information in this document is accurate. However, we cannot be held responsible for any errors or omissions.

MEI is ISO 9001:2000 certified.

©2010 MEI. All rights reserved.

